

strandTM

by **LaminexTM**
NEW ZEALAND

strandfloor[®]

strandfloorH3.1[®]

strandboard[®]

strandsarking[®]

Red List
Free

ENVIRONMENTAL LIVING
FUTURE PARTNER

Declare.

Product description

Strandfloor® is a high density reconstituted wood panel bonded with moisture resistant resin and wax, specifically formulated for use as residential and commercial interior floor platforms. When installed and maintained in accordance with the Strandfloor® technical manual, it complies with the NZ Building Code.

Strandfloor® consists of strands of pinus radiata randomly layered to form an aesthetically attractive wood based panel. Using a pMDI resin (formaldehyde free resin) system plus heat and pressure, wood strands are bonded together to form high density panels. A wax emulsion is added at this stage for additional moisture resistance to the strands.

StrandfloorH3.1® has a water based insecticide and fungicide added to provide superior performance when exposed to moisture.

The long edges of the Tongue & Groove sheets are machined to accommodate a plastic tongue which is inserted into one of the grooves. Strandfloor® Tongue & Groove has a white tongue while StrandfloorH3.1® has a green tongue.

Diaphragm Information

Strandfloor® has been independently tested for use as a structural panel for Specific Engineer Design Diaphragms. Refer to Strandfloor® Technical Manual, 5.2.3 SED structural diaphragms - pages 14 & 15.

Strandfloor® Average Shear Modulus Characteristic Properties				
Product		Shear Modulus (GPa)	Shear Modulus (MPa)	Shear Strength (MPa)
Strandfloor Statistics	Across Average	1.50	1500	8.73
	Along Average	1.47	1470	8.72
	All Specimens Average	1.49	1490	8.58
	All Specimens Coefficient of variation	10.2%	10.20%	

Independent testing undertaken by BRANZ Structural Engineering Laboratory. Testing was in accordance with ISO 46572:2008, for determining shear modulus in Panel Products using method B. (BRANZ test report ST-10888-001-01)

There are four product options all 20mm thick to cover your building requirements.

Strandfloor® Square Edge is an all-purpose wood based high density flooring material.

Strandfloor® Tongue & Groove is identical to Strandfloor® Square Edge in its manufacture but has the enhancement of a polypropylene tongue that gives the required sheer strength and eliminates the need for solid timber nogs to the long edge.

StrandfloorH3.1® Square Edge is the premium flooring material. Improved resin composition provides increased weathering performance with the added benefit of meeting New Zealand building requirements for use in wet areas.

StrandfloorH3.1® Tongue & Groove is identical to StrandfloorH3.1® Square Edge in its manufacture but has the enhancement of a polypropylene tongue that gives the required sheer strength and eliminates the need for solid timber nogs to the long edges.

Panel dimensions			
	Panel sizes mm	Weight (kg) per m2	Weight (kg) per panel
Square Edge	3600 x 2400 x 20	13.6	117.5*
	3600 x 1200 x 20	13.6	58.8
	2400 x 1200 x 20	13.6	39.2
Tongue&Groove	3600 x 1200 x 20	13.6	58.8
	2400 x 1200 x 20	13.6	39.2
H3.1 Square Edge	3600 x 2400 x 20	13.6	117.5*
	3600 x 1200 x 20	13.6	58.8
	2400 x 1200 x 20	13.6	39.2
H3.1 Tongue&Groove	3600 x 1200 x 20	13.6	58.8
	2400 x 1200 x 20	13.6	39.2

Red List Free

Strandfloor® is declared as Red List Free in the Declare Products Database. This is a globally recognised nutrition label for the building products industry, formed as part of the Living Building Challenge. Red List Free products have all ingredients disclosed in the Declare database and none of those ingredients appear on the Living Building Challenge Red List.

Laminex New Zealand™ Strandfloor® Selector

Which product to use?

Figure 1

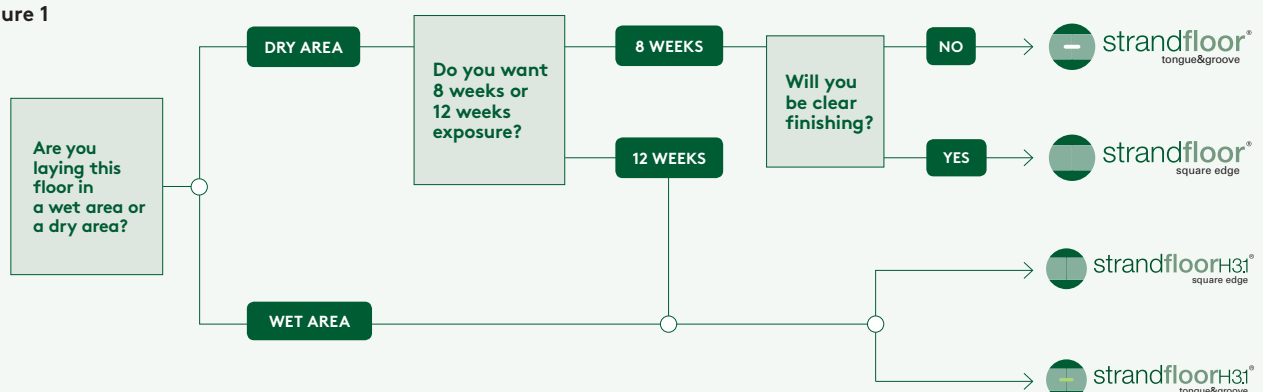

* Made to order.

Product description

Strandsarking®

- Is an engineered wood panel product specifically designed for use as a sarking under roofing materials that require continuous support.
- Is suitable to be used in residential, commercial and industrial roofing applications with a roof pitch of 2° or greater.
- Can be fastened to timber trusses or framing.
- Can be used with roof trusses or framing at a maximum of 900mm centres on roofs pitched at or above 9° or with roof trusses or framing at a maximum of 600mm centres on roofs pitched below 9°.
- Can be used with roofing materials weighing up to 150 kg/m² (see allowable spans section).
- Can be used in wind zones up to and including Extra High as specified in NZS 3604.
- Is nominally 16.3mm thick and has a textured surface to provide a more slip resistant surface than is available with smooth sanded panel products.
- Has been manufactured using sustainable plantation grown Radiata Pine, a highly durable formaldehyde free resin, and additional wax to improve moisture resistance. Strandsarking® has a water based insecticide and fungicide added to provide superior performance when exposed to moisture.
- Meets the requirements of hazard class H3.1.
- Meets the E zero classification for formaldehyde emissions when tested in accordance with AS/NZS 4266.16.
- Is identified by means of the words STRANDSARKING 165 64 H3.1 and the NZ Timber Preservation Council's WOODmark® symbol printed on the panel.
- Strandsarking® is H3.1 treated and can be exposed for 8 weeks.
- 100% New Zealand made.

Panel dimensions

Strandsarking® is available in the following panel size:

Panel size (mm)	Nominal mass per panel (kg)	Nominal mass per m ² (kg)
3600 x 800	32	11

Shear strength

Product	Property	Parallel	Perpendicular
Strandsarking®	Shear strength	8.76 MPa	7.82 MPa

Allowable spans

The specified span between centres is the horizontal measurement between centres of the roof framing members supporting the Strandsarking® panels.

Maximum imposed cladding weight	Span between centres
150kg/m ²	600 mm
50kg/m ²	900 mm

Red List Free

Strandsarking® is declared as Red List Free in the Declare Products Database. This is a globally recognised nutrition label for the building products industry, formed as part of the Living Building Challenge. Red List Free products have all ingredients disclosed in the Declare database and none of those ingredients appear on the Living Building Challenge Red List.



strandboard®

Product description

Strandboard® is a versatile reconstituted wood panel manufactured entirely from renewable plantation pine timber. It is designed specifically for a range of building and furniture & joinery applications.

Strandboard® is identified by its characteristic wood strand surface. The resin used has been developed to resist the effects of moisture in areas of high humidity and reduce the emission of formaldehyde.

Uses:

- o Wall and ceiling linings
- o Partitions – in general areas including changing rooms and toilets
- o Flooring overlays
- o General cabinet carcass work
- o Wall bracing

Panel dimensions

Strandboard® is available in the following panel size:

Panel dimensions			
	Panel sizes mm	Weight (kg) per m ²	Weight (kg) per panel
9mm	3600 x 1200	6.13	26.5
	2400 x 1200	6.13	17.7
12mm	3600 x 1200	8.19	35.4
	2400 x 1200	8.19	23.6
	3600 x 2400	8.19	70.8*

Nailing schedule		
	9mm	12mm
Nail size* (mm)	40 x 2.5	40 x 2.5
Fixing centres (mm) edges	150	150
Fixing centres (mm) intermediate	200	200
From sheet edge (mm)	10	10

*All fastenings must be corrosive resistant.

Wall bracing information		
Bracing units (BU) per metre	9mm	12mm
Wind	105	110
Earthquake	115	125

Red List Free

Strandboard® is declared as Red List Free in the Declare Products Database. This is a globally recognised nutrition label for the building products industry, formed as part of the Living Building Challenge. Red List Free products have all ingredients disclosed in the Declare database and none of those ingredients appear on the Living Building Challenge Red List.



* Made to order.

strandfloor®

Fire and Acoustic Floor System Fact Sheet.

Strandfloor® second layer installation

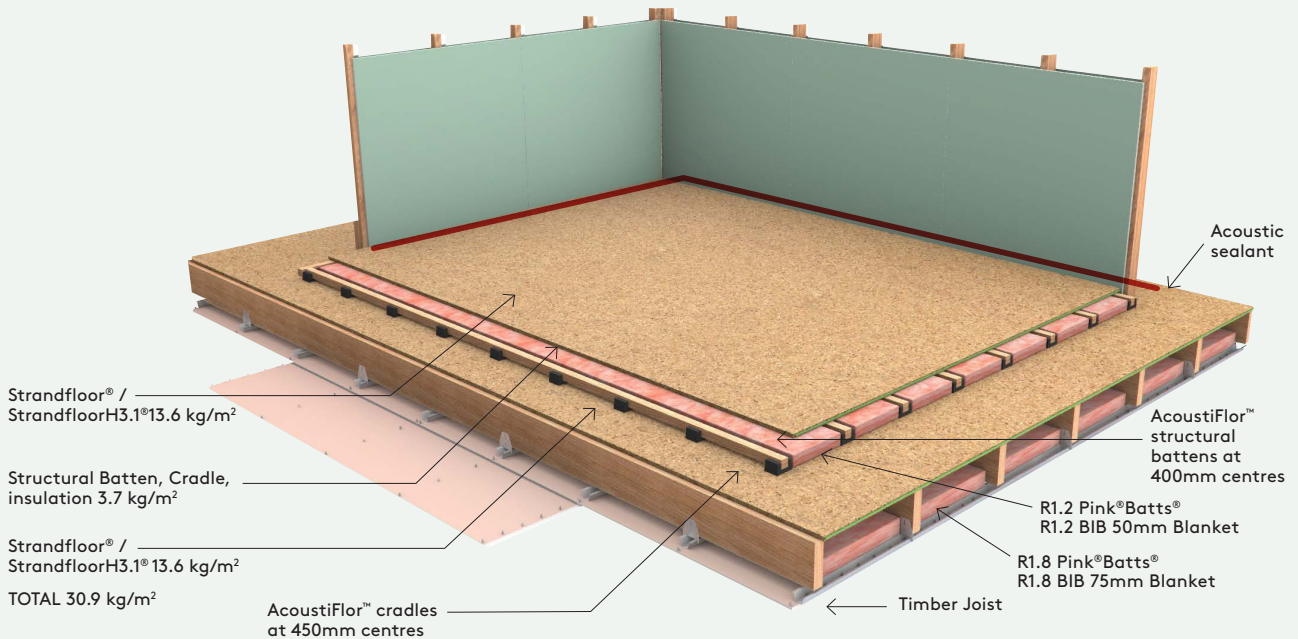

Benefits

- Tested lightweight timber construction fire and acoustic intertenancy flooring system.
- Acoustic performance = STC 65 / IIC 56.
- Independently tested by Auckland University and verified by Marshall Day Acoustics.
- Concentrated load of 3.6kN and Uniform Distributed Load of 4kPa (office and retail loadings as defined in AS/NZS 1170).

Ease of use on site:

- «Strandfloor® is lighter than comparable solutions.
- «Strandfloor® & StrandfloorH3.1® engineered wood panels do not require specialist cutting equipment.
- Multiple sheet sizes available – 3600 x 1200 mm and 2400 x 1200 mm.
- StrandfloorH3.1® for use in wet areas and increased exposure times.

- Level entry shower detail option.
- Fire performance of FRR 60/60/60 tested by BRANZ.
- Concrete slab overlay solution for existing or new buildings.
- Health and Safety – No specialist equipment needed.

Concrete mid floor

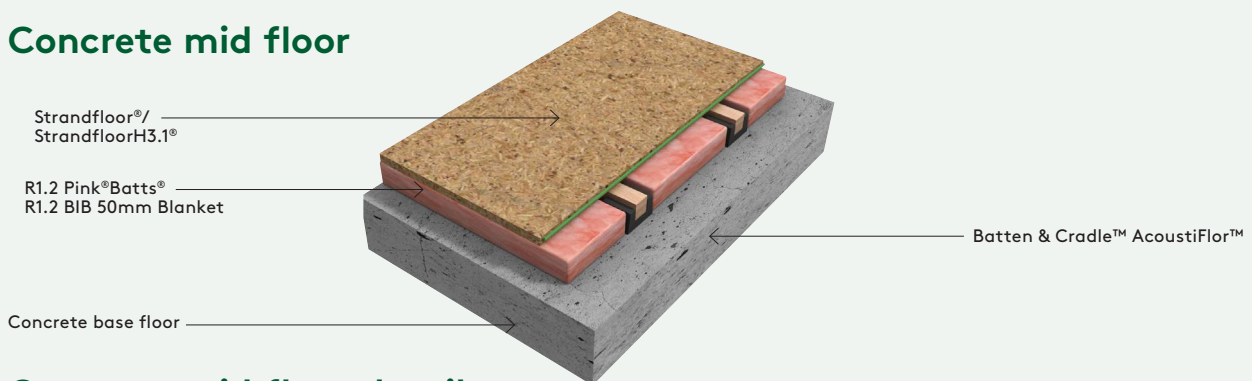

Concrete mid floor detail

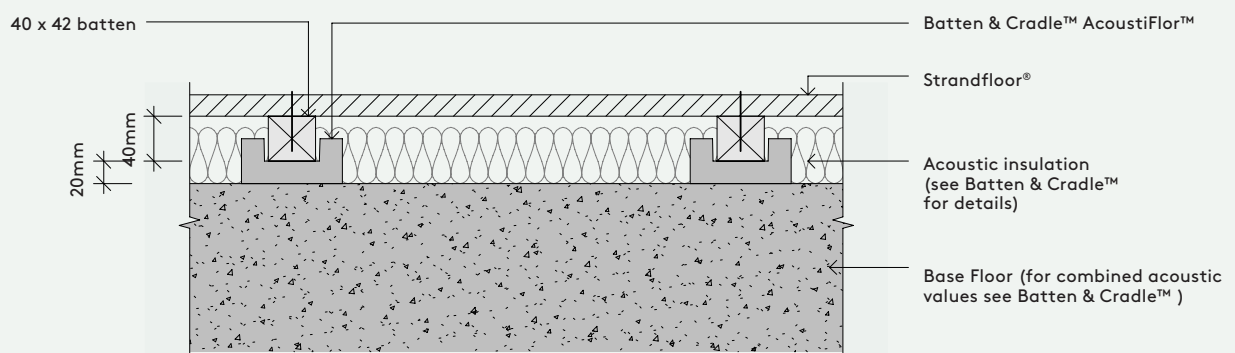

strandfloor®

strandfloorH3.1®

strandboard®

strandsarking®

VISIT US

laminex.co.nz

CALL US

0800 303 606

This brochure must be read in conjunction with the current Strandfloor® and Strandsarking® technical manuals. Laminex New Zealand™ will not be liable to any person if the instructions as to storage, use and installation of Strandfloor® and Strandsarking® as outlined in this brochure and Strandboard® and Strandfloor® Fire and Acoustic Technical Manual or referenced literature are not complied with. It is the obligation of the installer of Strandfloor®, Strandboard® and/or Strandsarking® to communicate the information conveyed in this brochure to the relevant owner/occupier. For all health and safety technical support information, please contact Laminex New Zealand™ customer service department or refer to technical manuals. Information is also found on masterspec.co.nz. Any proprietary products referred to in this brochure must be used in accordance with the relevant manufacturer's instructions. Laminex New Zealand™ accepts no liability for these proprietary products. Nothing contained in this paragraph or elsewhere in this brochure affects any rights a person may have under the Consumer Guarantees Act 1993. This brochure supersedes all previous issues. All Acts, Codes and Standards referred to in this brochure are the current editions at the date of brochure publication. J006593 1/20

©Copyright Reserved 2019, Laminex New Zealand™. Strandfloor®, Strandboard® and Strandsarking® are marketed and distributed by Laminex New Zealand™, a division of Fletcher Building Products Limited. Strandfloor, Square Edge, Strandfloor Square Edge logo, Strandfloor Tongue & Groove, Strandfloor Tongue & Groove logo, StrandfloorH3.1 Tongue & Groove, StrandfloorH3.1 Tongue & Groove logo, StrandfloorH3.1 Square Edge, StrandfloorH3.1 Square Edge logo and IBUILT are the trademarks of Fletcher Building Holdings and used under licence by Laminex New Zealand™, a division of Fletcher Building Products Ltd. Laminex New Zealand™ and Trade Essentials are used under licence by Laminex New Zealand™, a division of Fletcher Building Products Ltd.

Laminex™
NEW ZEALAND